

**veris**



SCALE 1:250  
0 5m  
611606 July 2023

- Retaining Wall
- Lot Level
- Footpath

- Street Light
- Drainage
- Power Dome
- Drainage Lot Connection

- Water Service
- NBN Pit
- Sewer Service

**6365 4620** | [info@parcelproperty.com.au](mailto:info@parcelproperty.com.au)  
[www.brightwoodbalddivis.com.au](http://www.brightwoodbalddivis.com.au)

**parcel.**

DISCLAIMER: Whilst every care has been taken with the preparation of these particulars, which are believed to be correct, they are in no way warranted by the selling agent or its clients in whole or in part and should not be construed as forming part of any contract. The particulars of this plan are supplied for identification purposes only and shall not be taken as a representation in any aspect on the part of the vendor or its agents. Authorities should be consulted when services are contained within lot boundaries as building restrictions may apply. All retaining walls, services and associated easements are shown exaggerated for legibility. Trees for marketing purposes are indicative only. Street tree locations have been approved by the City of Rockingham. The purchaser and their builder must take notice of these locations prior to submitting a Building Application. The developer is not responsible for the relocation of any street trees. Any intending purchasers are advised to make necessary enquiries to satisfy themselves on all matters in this respect. Sales Agent: Parcel Realty Pty Ltd (ABN 66 153 825 542). Licence number: 64283.

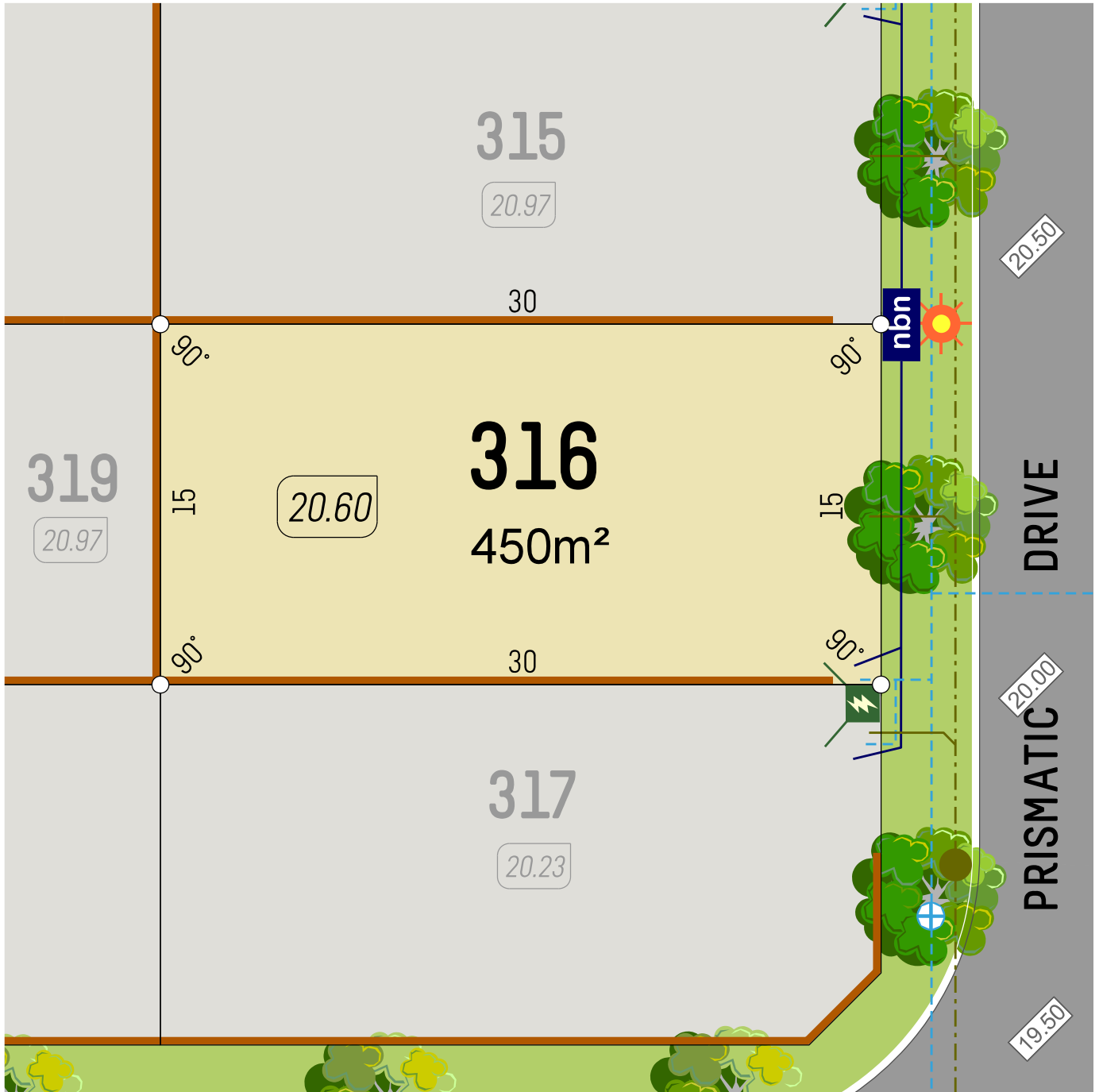

**veris**



SCALE 1:250  
0 5m  
611606 July 2023

- Retaining Wall
- Lot Level
- Footpath

- Street Light
- Drainage
- Power Dome
- Drainage Lot Connection

- Water Service
- NBN Pit
- Sewer Service

**6365 4620** | [info@parcelproperty.com.au](mailto:info@parcelproperty.com.au)  
[www.brightwoodbalddivis.com.au](http://www.brightwoodbalddivis.com.au)

**parcel.**

DISCLAIMER: Whilst every care has been taken with the preparation of these particulars, which are believed to be correct, they are in no way warranted by the selling agent or its clients in whole or in part and should not be construed as forming part of any contract. The particulars of this plan are supplied for identification purposes only and shall not be taken as a representation in any aspect on the part of the vendor or its agents. Authorities should be consulted when services are contained within lot boundaries as building restrictions may apply. All retaining walls, services and associated easements are shown exaggerated for legibility. Trees for marketing purposes are indicative only. Street tree locations have been approved by the City of Rockingham. The purchaser and their builder must take notice of these locations prior to submitting a Building Application. The developer is not responsible for the relocation of any street trees. Any intending purchasers are advised to make necessary enquiries to satisfy themselves on all matters in this respect. Sales Agent: Parcel Realty Pty Ltd (ABN 66 153 825 542). Licence number: 64283.

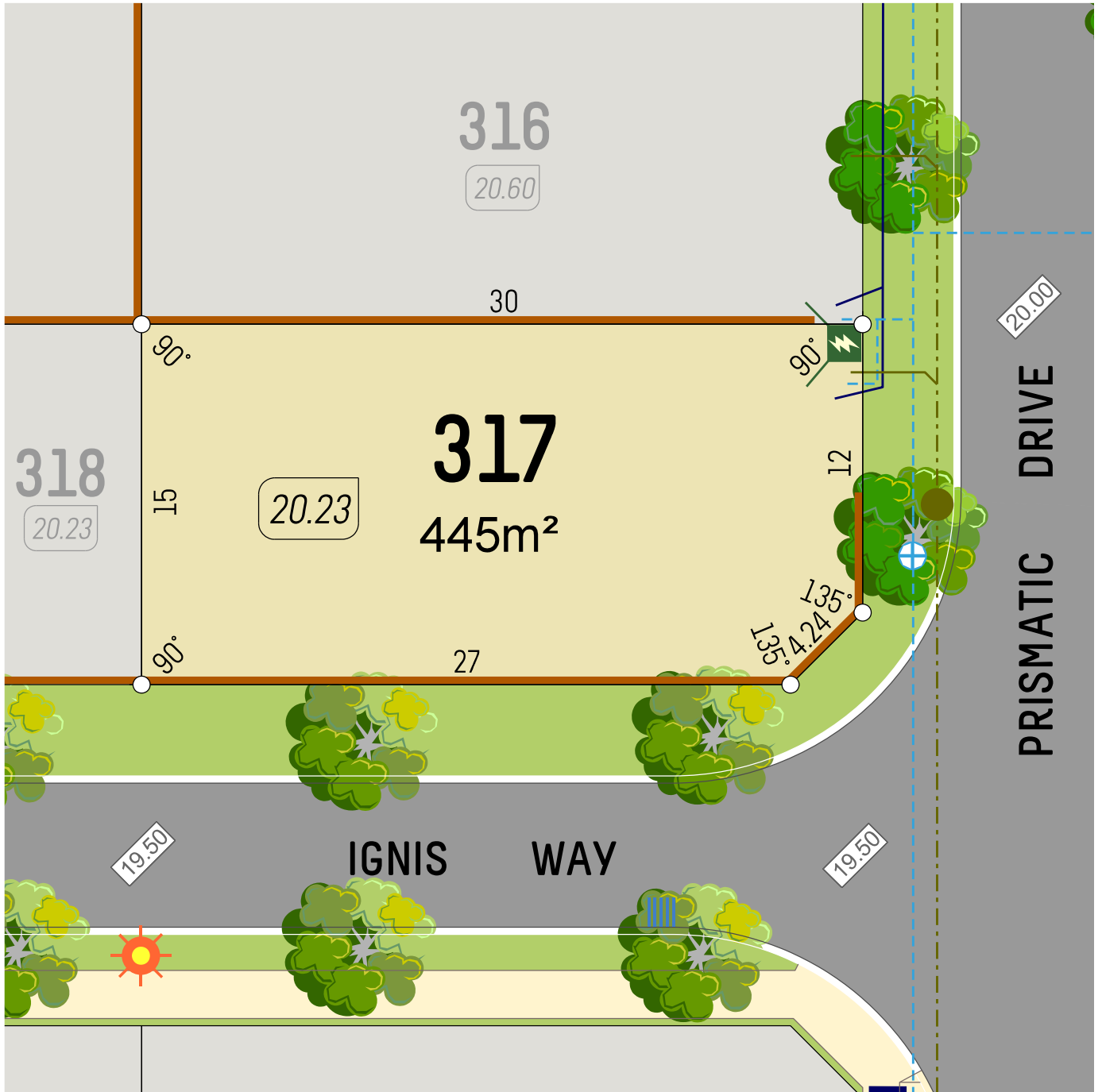

**veris**



SCALE 1:250  
611606 July 2023

- Retaining Wall
- Lot Level
- Footpath

- Street Light
- Drainage
- Power Dome
- Drainage Lot Connection

- Water Service
- NBN Pit
- Sewer Service

**6365 4620** | [info@parcelproperty.com.au](mailto:info@parcelproperty.com.au)  
[www.brightwoodbalddivis.com.au](http://www.brightwoodbalddivis.com.au)

**parcel.**

DISCLAIMER: Whilst every care has been taken with the preparation of these particulars, which are believed to be correct, they are in no way warranted by the selling agent or its clients in whole or in part and should not be construed as forming part of any contract. The particulars of this plan are supplied for identification purposes only and shall not be taken as a representation in any aspect on the part of the vendor or its agents. Authorities should be consulted when services are contained within lot boundaries as building restrictions may apply. All retaining walls, services and associated easements are shown exaggerated for legibility. Trees for marketing purposes are indicative only. Street tree locations have been approved by the City of Rockingham. The purchaser and their builder must take notice of these locations prior to submitting a Building Application. The developer is not responsible for the relocation of any street trees. Any intending purchasers are advised to make necessary enquiries to satisfy themselves on all matters in this respect. Sales Agent: Parcel Realty Pty Ltd (ABN 66 153 825 542). Licence number: 64283.

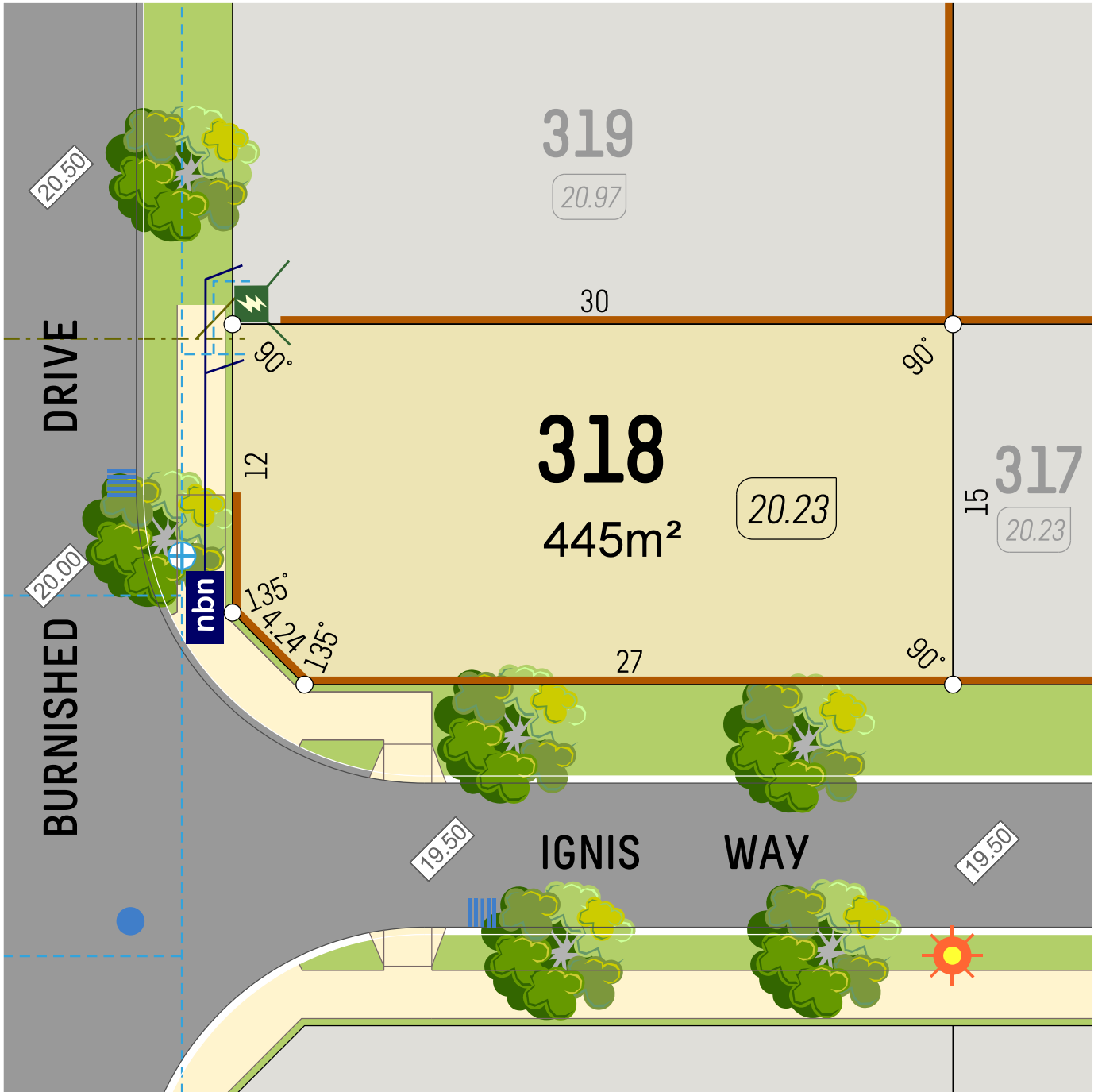

SCALE 1:250  
611606 July 2023

- Retaining Wall
- Lot Level
- Footpath
- Street Light
- Drainage
- Power Dome
- Drainage Lot Connection
- Water Service
- NBN Pit
- Sewer Service

**6365 4620** | [info@parcelproperty.com.au](mailto:info@parcelproperty.com.au)  
[www.brightwoodbalddivis.com.au](http://www.brightwoodbalddivis.com.au)



DISCLAIMER: Whilst every care has been taken with the preparation of these particulars, which are believed to be correct, they are in no way warranted by the selling agent or its clients in whole or in part and should not be construed as forming part of any contract. The particulars of this plan are supplied for identification purposes only and shall not be taken as a representation in any aspect on the part of the vendor or its agents. Authorities should be consulted when services are contained within lot boundaries as building restrictions may apply. All retaining walls, services and associated easements are shown exaggerated for legibility. Trees for marketing purposes are indicative only. Street tree locations have been approved by the City of Rockingham. The purchaser and their builder must take notice of these locations prior to submitting a Building Application. The developer is not responsible for the relocation of any street trees. Any intending purchasers are advised to make necessary enquiries to satisfy themselves on all matters in this respect. Sales Agent: Parcel Realty Pty Ltd (ABN 66 153 825 542). Licence number: 64283.

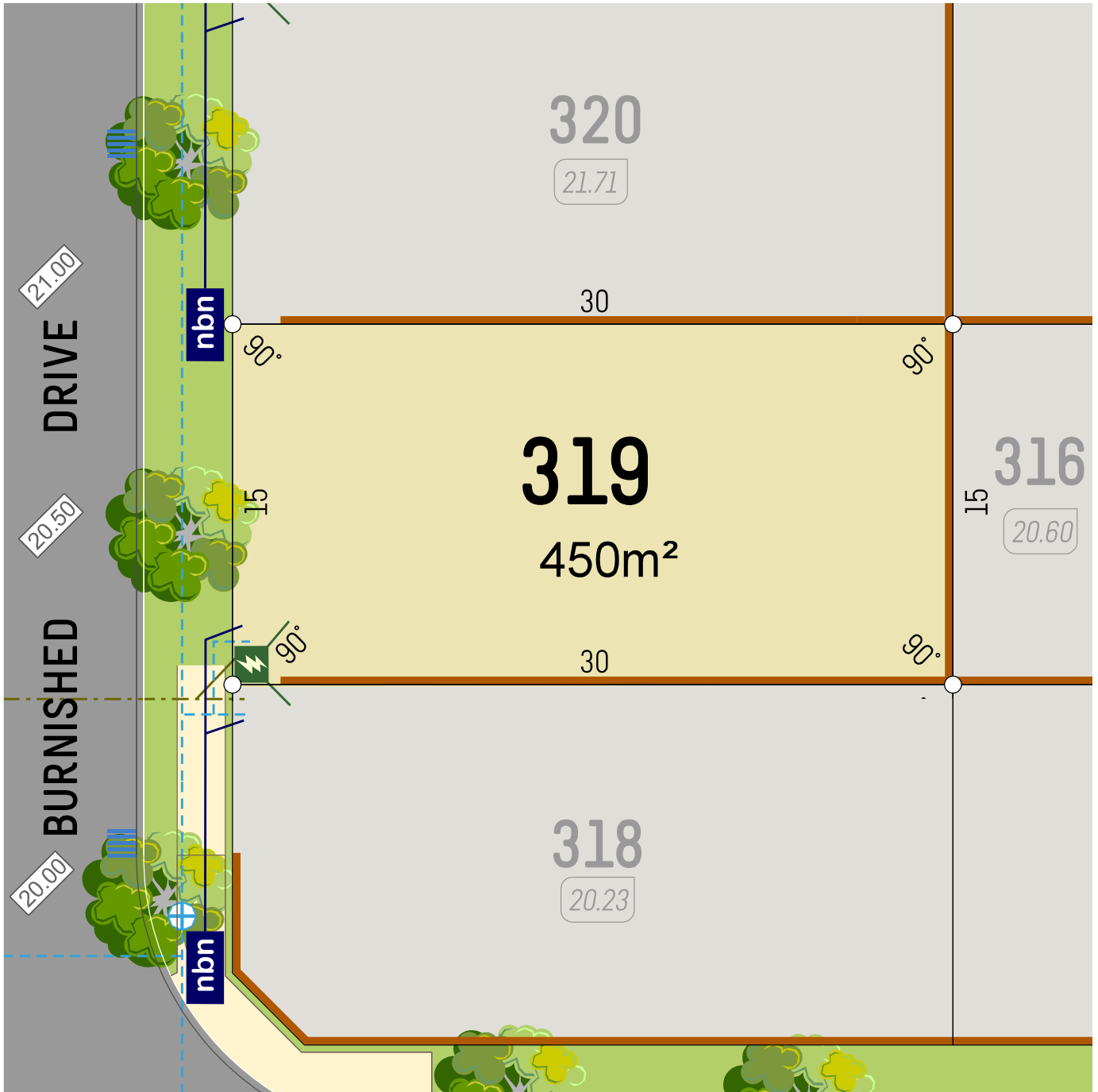

**veris**



SCALE 1:250  
5m  
611606 July 2023

- Retaining Wall
- Lot Level
- Footpath

- Street Light
- Drainage
- Power Dome
- Drainage Lot Connection

- Water Service
- NBN Pit
- Sewer Service

**6365 4620** | [info@parcelproperty.com.au](mailto:info@parcelproperty.com.au)  
[www.brightwoodbalddivis.com.au](http://www.brightwoodbalddivis.com.au)

**parcel.**

DISCLAIMER: Whilst every care has been taken with the preparation of these particulars, which are believed to be correct, they are in no way warranted by the selling agent or its clients in whole or in part and should not be construed as forming part of any contract. The particulars of this plan are supplied for identification purposes only and shall not be taken as a representation in any aspect on the part of the vendor or its agents. Authorities should be consulted when services are contained within lot boundaries as building restrictions may apply. All retaining walls, services and associated easements are shown exaggerated for legibility. Trees for marketing purposes are indicative only. Street tree locations have been approved by the City of Rockingham. The purchaser and their builder must take notice of these locations prior to submitting a Building Application. The developer is not responsible for the relocation of any street trees. Any intending purchasers are advised to make necessary enquiries to satisfy themselves on all matters in this respect. Sales Agent: Parcel Realty Pty Ltd (ABN 66 153 825 542). Licence number: 64283.

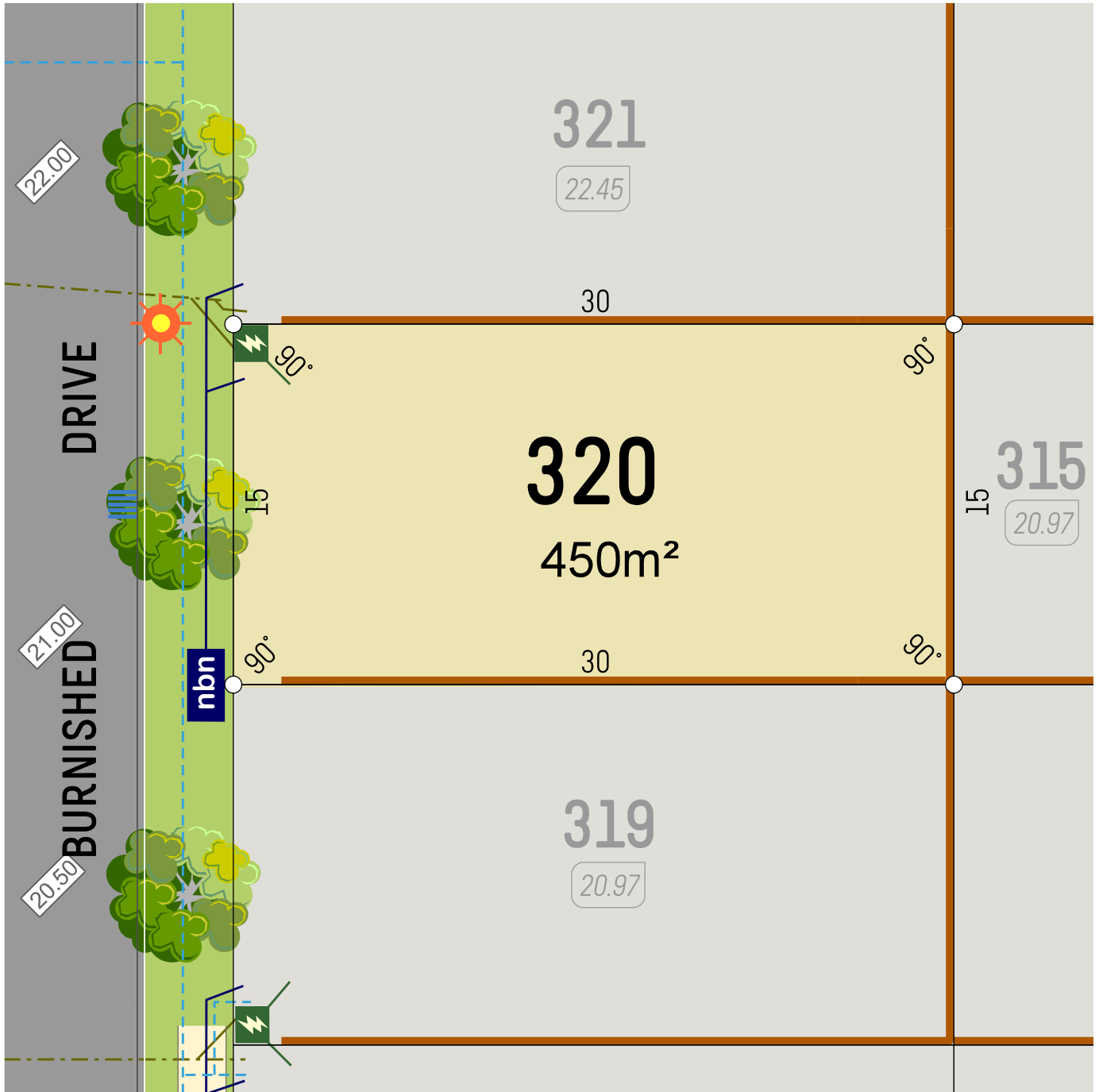

**veris**



SCALE 1:250  
611606 July 2023

- Retaining Wall
- Lot Level
- Footpath

- Street Light
- Drainage
- Power Dome
- Drainage Lot Connection

- Water Service
- NBN Pit
- Sewer Service

**6365 4620** | [info@parcelproperty.com.au](mailto:info@parcelproperty.com.au)  
[www.brightwoodbalddivis.com.au](http://www.brightwoodbalddivis.com.au)

**parcel.**

DISCLAIMER: Whilst every care has been taken with the preparation of these particulars, which are believed to be correct, they are in no way warranted by the selling agent or its clients in whole or in part and should not be construed as forming part of any contract. The particulars of this plan are supplied for identification purposes only and shall not be taken as a representation in any aspect on the part of the vendor or its agents. Authorities should be consulted when services are contained within lot boundaries as building restrictions may apply. All retaining walls, services and associated easements are shown exaggerated for legibility. Trees for marketing purposes are indicative only. Street tree locations have been approved by the City of Rockingham. The purchaser and their builder must take notice of these locations prior to submitting a Building Application. The developer is not responsible for the relocation of any street trees. Any intending purchasers are advised to make necessary enquiries to satisfy themselves on all matters in this respect. Sales Agent: Parcel Realty Pty Ltd (ABN 66 153 825 542). Licence number: 64283.



**veris**



SCALE 1:250

611606 July 2023

- Retaining Wall
- Lot Level
- Footpath

- Street Light
- Drainage
- Power Dome
- Drainage Lot Connection

- Water Service
- NBN Pit
- Sewer Service

**6365 4620** | [info@parcelproperty.com.au](mailto:info@parcelproperty.com.au)  
[www.brightwoodbalddivis.com.au](http://www.brightwoodbalddivis.com.au)

**parcel.**

DISCLAIMER: Whilst every care has been taken with the preparation of these particulars, which are believed to be correct, they are in no way warranted by the selling agent or its clients in whole or in part and should not be construed as forming part of any contract. The particulars of this plan are supplied for identification purposes only and shall not be taken as a representation in any aspect on the part of the vendor or its agents. Authorities should be consulted when services are contained within lot boundaries as building restrictions may apply. All retaining walls, services and associated easements are shown exaggerated for legibility. Trees for marketing purposes are indicative only. Street tree locations have been approved by the City of Rockingham. The purchaser and their builder must take notice of these locations prior to submitting a Building Application. The developer is not responsible for the relocation of any street trees. Any intending purchasers are advised to make necessary enquiries to satisfy themselves on all matters in this respect. Sales Agent: Parcel Realty Pty Ltd (ABN 66 153 825 542). Licence number: 64283.



**veris**



SCALE 1:250  
611606 July 2023

- Retaining Wall
- Lot Level
- Footpath

- Street Light
- Drainage
- Power Dome
- Drainage Lot Connection

- Water Service
- NBN Pit
- Sewer Service

**6365 4620** | [info@parcelproperty.com.au](mailto:info@parcelproperty.com.au)  
[www.brightwoodbalddivis.com.au](http://www.brightwoodbalddivis.com.au)

**parcel.**

DISCLAIMER: Whilst every care has been taken with the preparation of these particulars, which are believed to be correct, they are in no way warranted by the selling agent or its clients in whole or in part and should not be construed as forming part of any contract. The particulars of this plan are supplied for identification purposes only and shall not be taken as a representation in any aspect on the part of the vendor or its agents. Authorities should be consulted when services are contained within lot boundaries as building restrictions may apply. All retaining walls, services and associated easements are shown exaggerated for legibility. Trees for marketing purposes are indicative only. Street tree locations have been approved by the City of Rockingham. The purchaser and their builder must take notice of these locations prior to submitting a Building Application. The developer is not responsible for the relocation of any street trees. Any intending purchasers are advised to make necessary enquiries to satisfy themselves on all matters in this respect. Sales Agent: Parcel Realty Pty Ltd (ABN 66 153 825 542). Licence number: 64283.



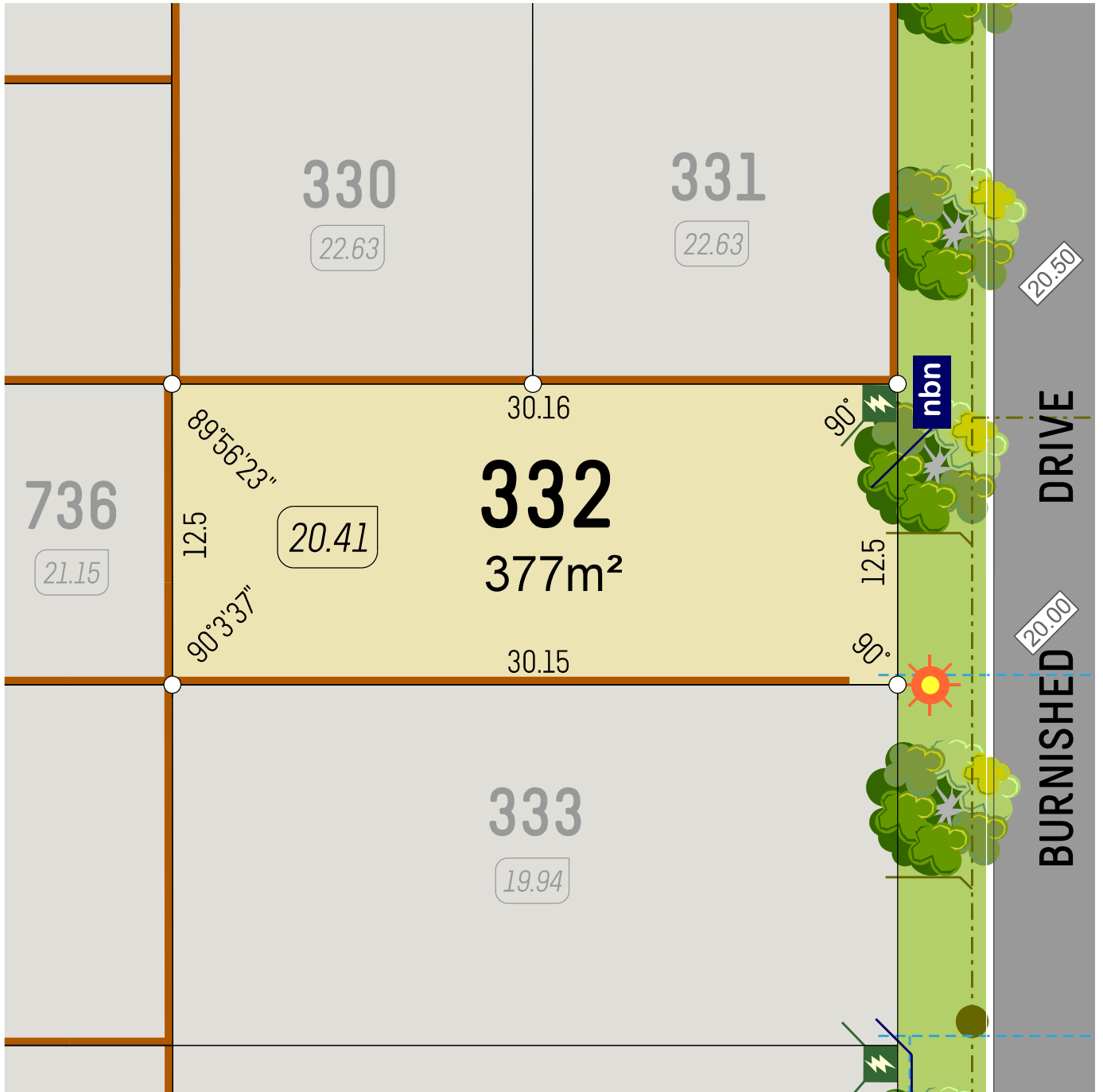

veris



SCALE 1:250  
611606 July 2023

- Retaining Wall
- Lot Level
- Footpath

- Street Light
- Drainage
- Power Dome
- Drainage Lot Connection

- Water Service
- NBN Pit
- Sewer Service

6365 4620 | info@parcelproperty.com.au  
www.brightwoodbalddivis.com.au

parcel.

DISCLAIMER: Whilst every care has been taken with the preparation of these particulars, which are believed to be correct, they are in no way warranted by the selling agent or its clients in whole or in part and should not be construed as forming part of any contract. The particulars of this plan are supplied for identification purposes only and shall not be taken as a representation in any aspect on the part of the vendor or its agents. Authorities should be consulted when services are contained within lot boundaries as building restrictions may apply. All retaining walls, services and associated easements are shown exaggerated for legibility. Trees for marketing purposes are indicative only. Street tree locations have been approved by the City of Rockingham. The purchaser and their builder must take notice of these locations prior to submitting a Building Application. The developer is not responsible for the relocation of any street trees. Any intending purchasers are advised to make necessary enquiries to satisfy themselves on all matters in this respect. Sales Agent: Parcel Realty Pty Ltd (ABN 66 153 825 542). Licence number: 64283.

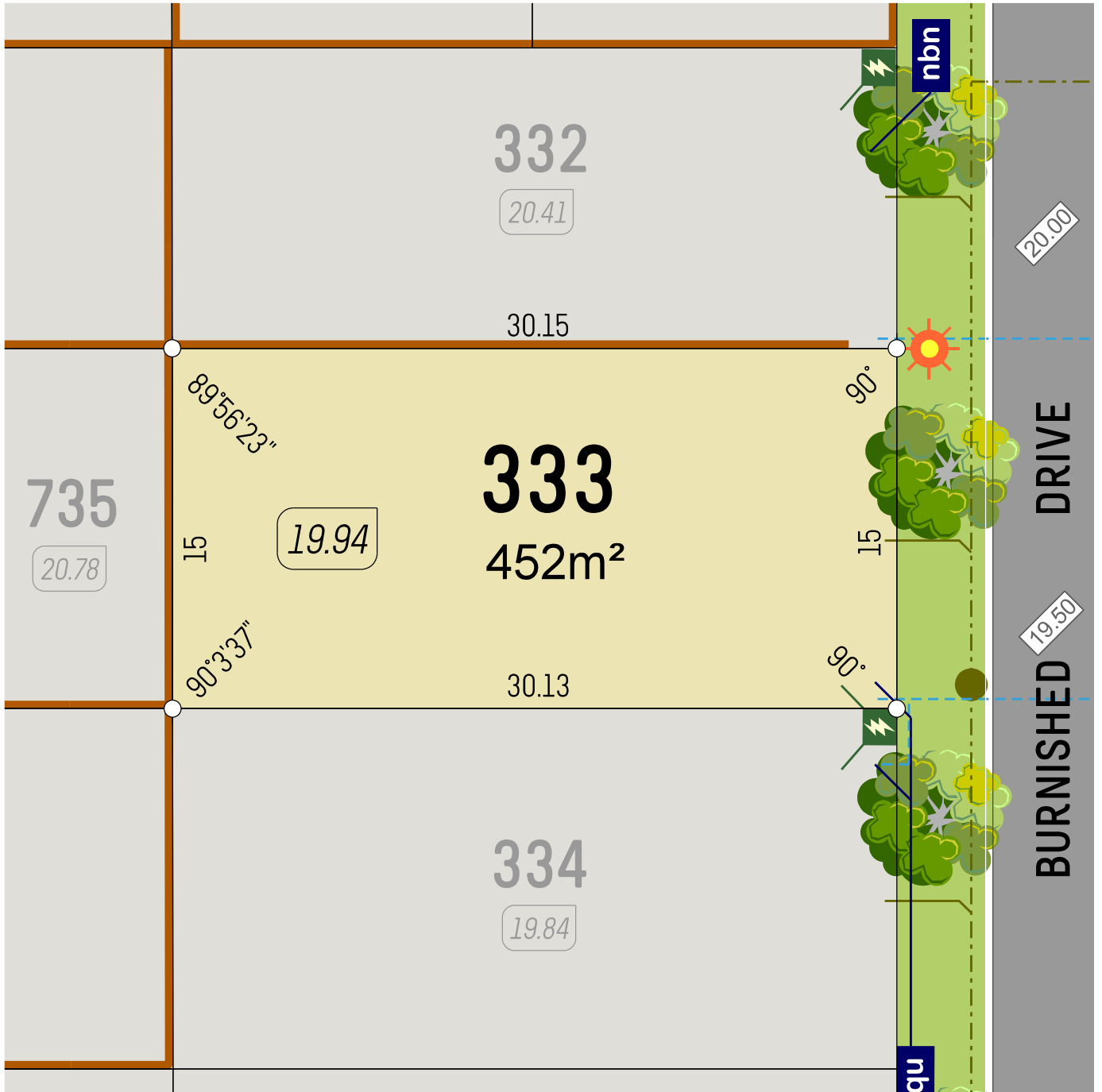

veris



SCALE 1:250  
611606 July 2023

- Retaining Wall
- Lot Level
- Footpath

- Street Light
- Drainage
- Power Dome
- Drainage Lot Connection

- Water Service
- NBN Pit
- Sewer Service

6365 4620 | [info@parcelproperty.com.au](mailto:info@parcelproperty.com.au)  
[www.brightwoodbalddivis.com.au](http://www.brightwoodbalddivis.com.au)

parcel.

DISCLAIMER: Whilst every care has been taken with the preparation of these particulars, which are believed to be correct, they are in no way warranted by the selling agent or its clients in whole or in part and should not be construed as forming part of any contract. The particulars of this plan are supplied for identification purposes only and shall not be taken as a representation in any aspect on the part of the vendor or its agents. Authorities should be consulted when services are contained within lot boundaries as building restrictions may apply. All retaining walls, services and associated easements are shown exaggerated for legibility. Trees for marketing purposes are indicative only. Street tree locations have been approved by the City of Rockingham. The purchaser and their builder must take notice of these locations prior to submitting a Building Application. The developer is not responsible for the relocation of any street trees. Any intending purchasers are advised to make necessary enquiries to satisfy themselves on all matters in this respect. Sales Agent: Parcel Realty Pty Ltd (ABN 66 153 825 542). Licence number: 64283.

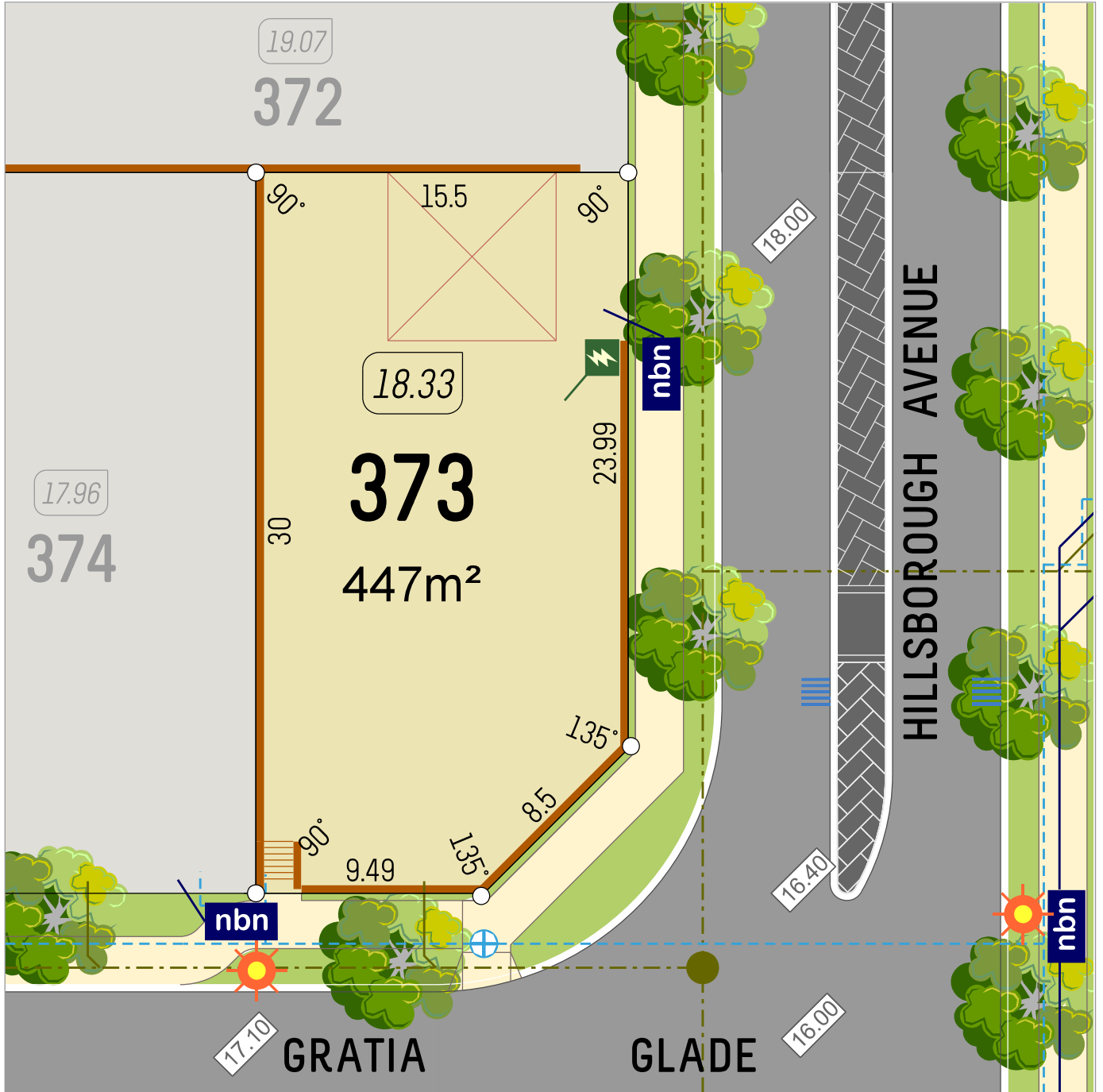

veris



SCALE 1:250  
611606 July 2023

- Retaining Wall
- Lot Level
- Footpath

- Street Light
- Drainage
- Power Dome
- Drainage Lot Connection

- Water Service
- NBN Pit
- Sewer Service

6365 4620 | info@parcelproperty.com.au  
www.brightwoodbalddivis.com.au

parcel.

DISCLAIMER: Whilst every care has been taken with the preparation of these particulars, which are believed to be correct, they are in no way warranted by the selling agent or its clients in whole or in part and should not be construed as forming part of any contract. The particulars of this plan are supplied for identification purposes only and shall not be taken as a representation in any aspect on the part of the vendor or its agents. Authorities should be consulted when services are contained within lot boundaries as building restrictions may apply. All retaining walls, services and associated easements are shown exaggerated for legibility. Trees for marketing purposes are indicative only. Street tree locations have been approved by the City of Rockingham. The purchaser and their builder must take notice of these locations prior to submitting a Building Application. The developer is not responsible for the relocation of any street trees. Any intending purchasers are advised to make necessary enquiries to satisfy themselves on all matters in this respect. Sales Agent: Parcel Realty Pty Ltd (ABN 66 153 825 542). Licence number: 64283.

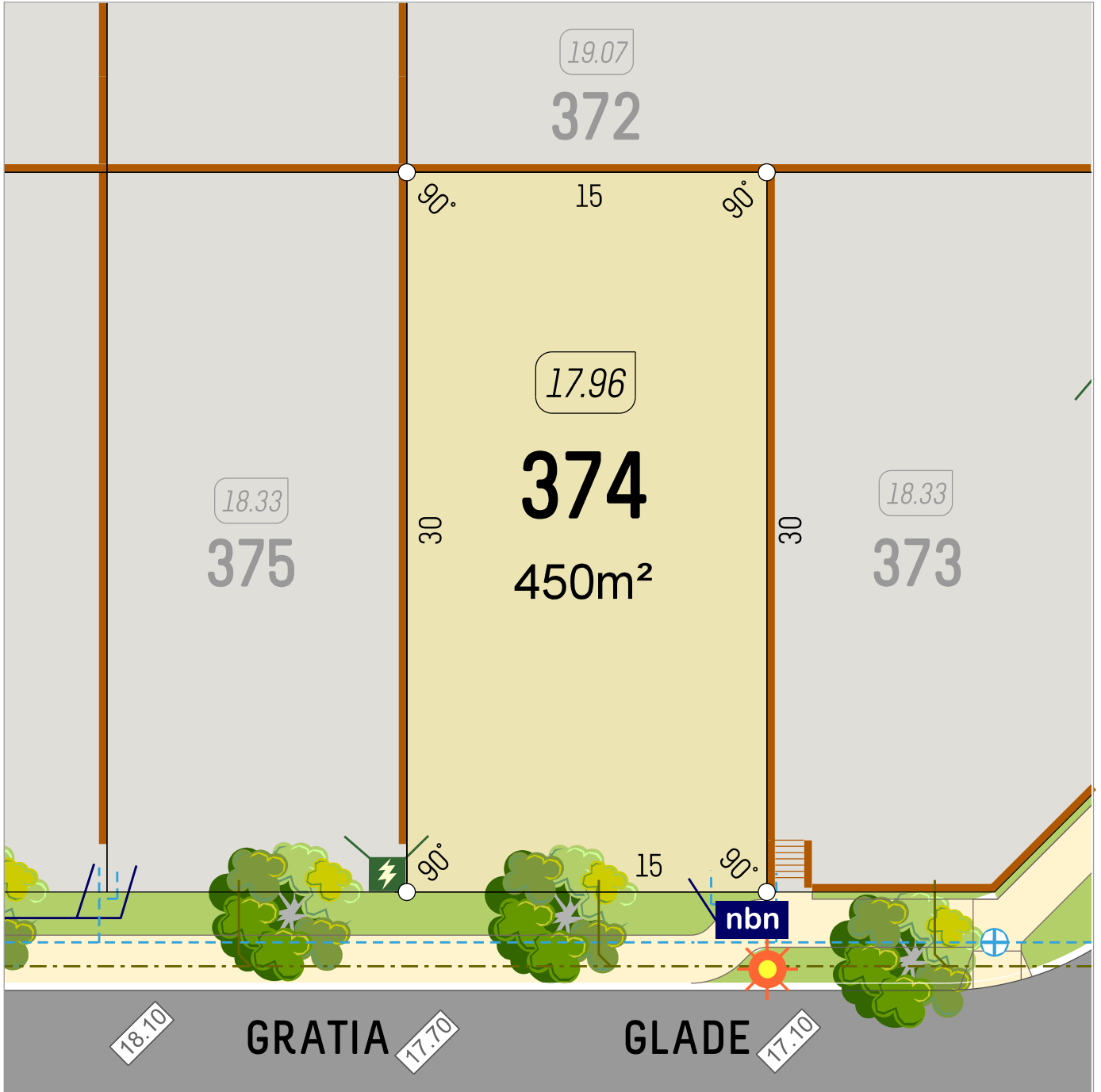

**veris**



SCALE 1:250  
611606 July 2023

- Retaining Wall
- Lot Level
- Footpath

- Street Light
- Drainage
- Power Dome
- Drainage Lot Connection

- Water Service
- NBN Pit
- Sewer Service

**6365 4620** | [info@parcelproperty.com.au](mailto:info@parcelproperty.com.au)  
[www.brightwoodbalddivis.com.au](http://www.brightwoodbalddivis.com.au)

**parcel.**

DISCLAIMER: Whilst every care has been taken with the preparation of these particulars, which are believed to be correct, they are in no way warranted by the selling agent or its clients in whole or in part and should not be construed as forming part of any contract. The particulars of this plan are supplied for identification purposes only and shall not be taken as a representation in any aspect on the part of the vendor or its agents. Authorities should be consulted when services are contained within lot boundaries as building restrictions may apply. All retaining walls, services and associated easements are shown exaggerated for legibility. Trees for marketing purposes are indicative only. Street tree locations have been approved by the City of Rockingham. The purchaser and their builder must take notice of these locations prior to submitting a Building Application. The developer is not responsible for the relocation of any street trees. Any intending purchasers are advised to make necessary enquiries to satisfy themselves on all matters in this respect. Sales Agent: Parcel Realty Pty Ltd (ABN 66 153 825 542). Licence number: 64283.

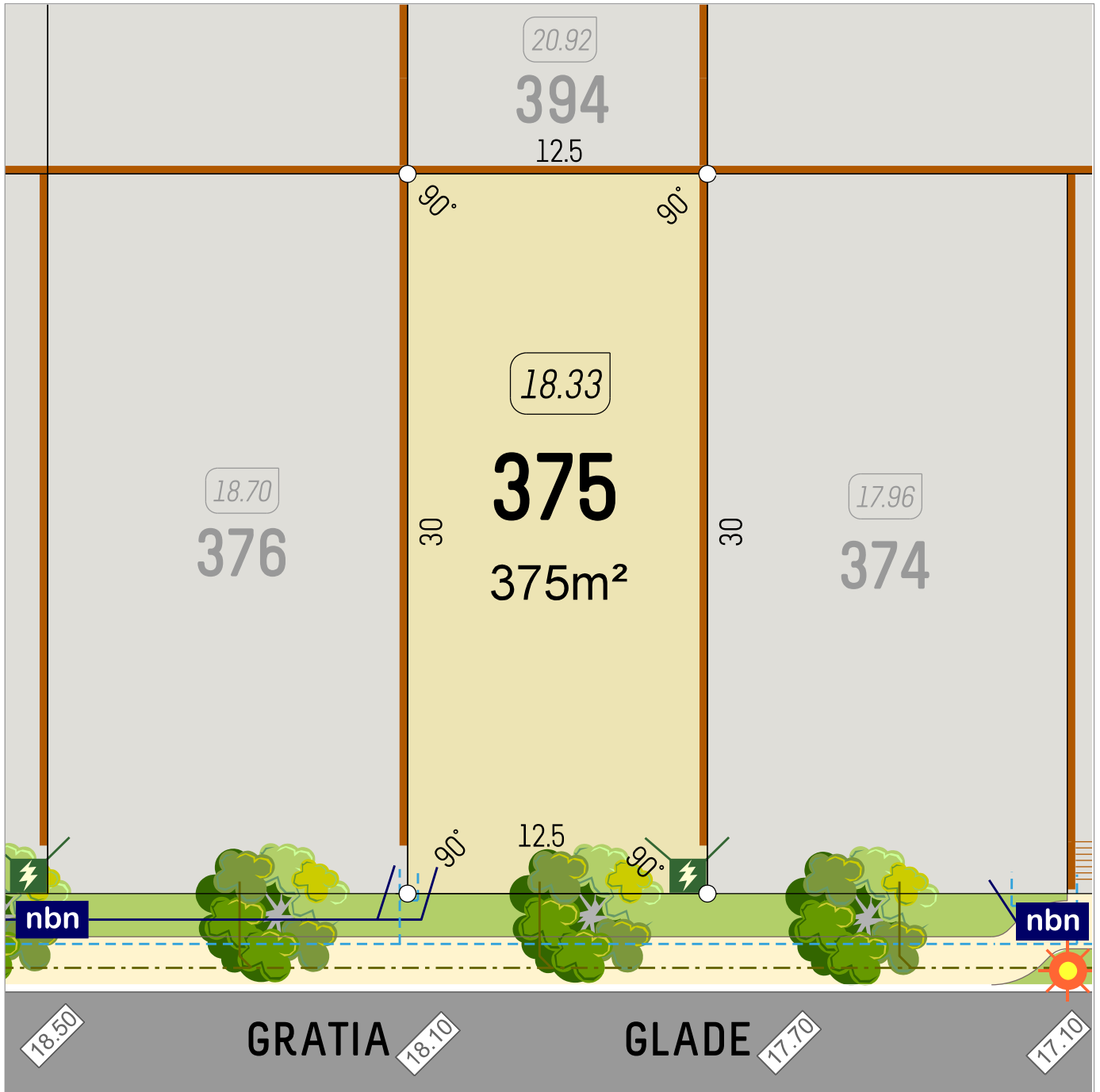

**veris**



SCALE 1:250  
611606 July 2023

- Retaining Wall
- Lot Level
- Footpath

- Street Light
- Drainage
- Power Dome
- Drainage Lot Connection

- Water Service
- NBN Pit
- Sewer Service

**6365 4620** | [info@parcelproperty.com.au](mailto:info@parcelproperty.com.au)  
[www.brightwoodbalddivis.com.au](http://www.brightwoodbalddivis.com.au)

**parcel.**

DISCLAIMER: Whilst every care has been taken with the preparation of these particulars, which are believed to be correct, they are in no way warranted by the selling agent or its clients in whole or in part and should not be construed as forming part of any contract. The particulars of this plan are supplied for identification purposes only and shall not be taken as a representation in any aspect on the part of the vendor or its agents. Authorities should be consulted when services are contained within lot boundaries as building restrictions may apply. All retaining walls, services and associated easements are shown exaggerated for legibility. Trees for marketing purposes are indicative only. Street tree locations have been approved by the City of Rockingham. The purchaser and their builder must take notice of these locations prior to submitting a Building Application. The developer is not responsible for the relocation of any street trees. Any intending purchasers are advised to make necessary enquiries to satisfy themselves on all matters in this respect. Sales Agent: Parcel Realty Pty Ltd (ABN 66 153 825 542). Licence number: 64283.

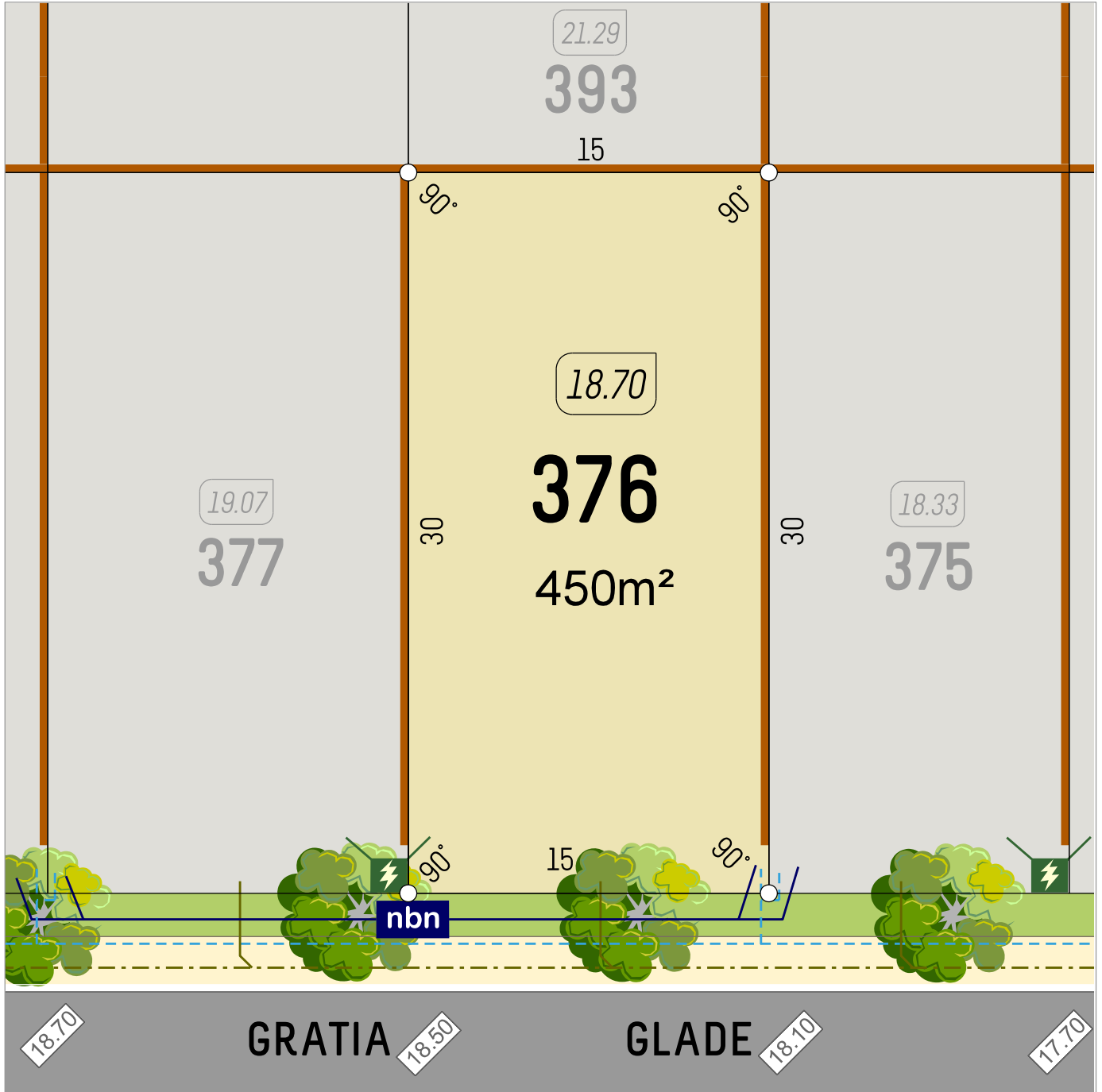

veris



SCALE 1:250  
0 5m  
611606 July 2023

- Retaining Wall
- Lot Level
- Footpath

- Street Light
- Drainage
- Power Dome
- Drainage Lot Connection

- Water Service
- NBN Pit
- Sewer Service

6365 4620 | info@parcelproperty.com.au  
www.brightwoodbalddivis.com.au

parcel.

DISCLAIMER: Whilst every care has been taken with the preparation of these particulars, which are believed to be correct, they are in no way warranted by the selling agent or its clients in whole or in part and should not be construed as forming part of any contract. The particulars of this plan are supplied for identification purposes only and shall not be taken as a representation in any aspect on the part of the vendor or its agents. Authorities should be consulted when services are contained within lot boundaries as building restrictions may apply. All retaining walls, services and associated easements are shown exaggerated for legibility. Trees for marketing purposes are indicative only. Street tree locations have been approved by the City of Rockingham. The purchaser and their builder must take notice of these locations prior to submitting a Building Application. The developer is not responsible for the relocation of any street trees. Any intending purchasers are advised to make necessary enquiries to satisfy themselves on all matters in this respect. Sales Agent: Parcel Realty Pty Ltd (ABN 66 153 825 542). Licence number: 64283.

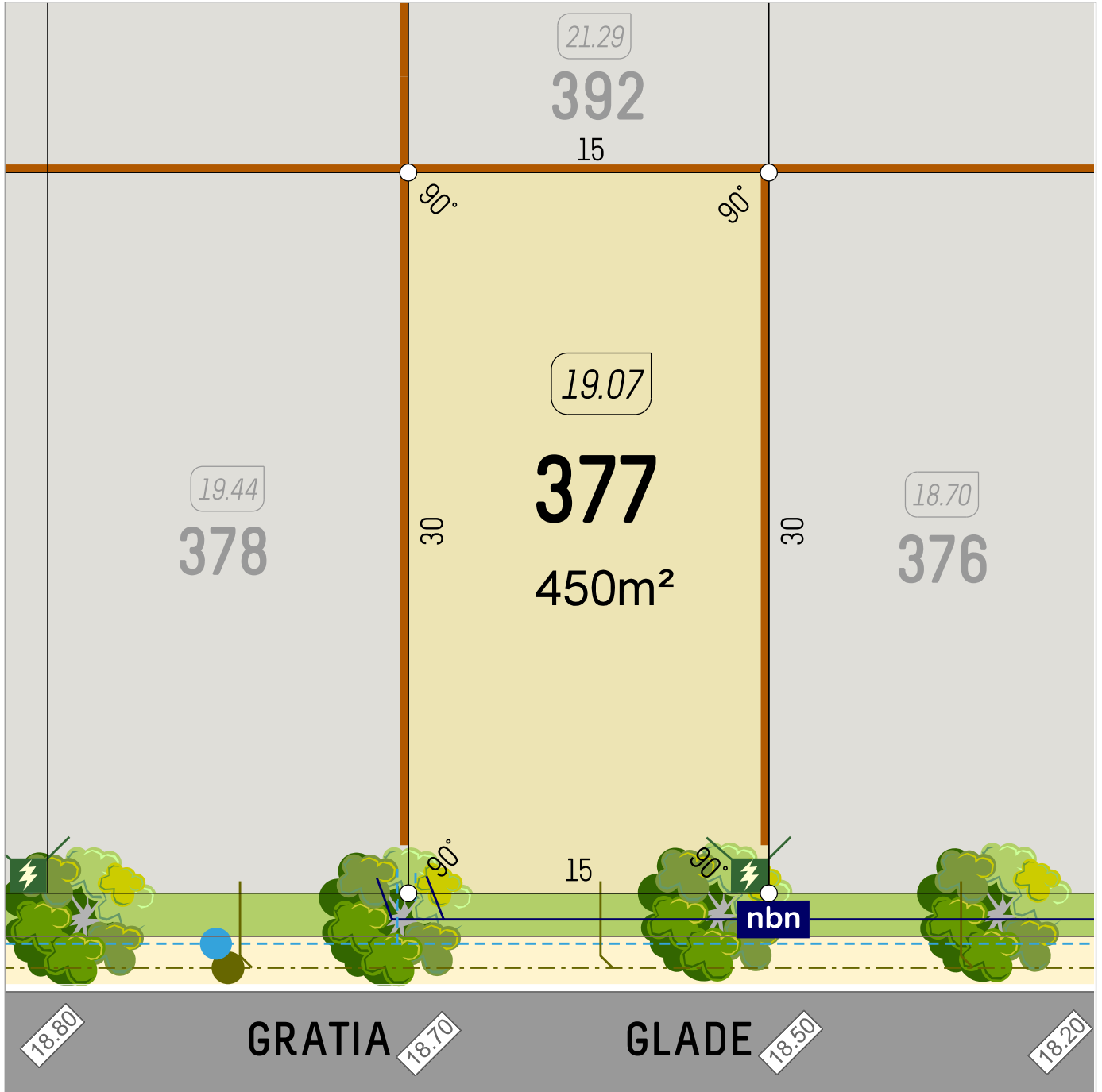

**veris**



SCALE 1:250  
611606 July 2023

- Retaining Wall
- Lot Level
- Footpath

- Street Light
- Drainage
- Power Dome
- Drainage Lot Connection

- Water Service
- NBN Pit
- Sewer Service

**6365 4620** | [info@parcelproperty.com.au](mailto:info@parcelproperty.com.au)  
[www.brightwoodbalddivis.com.au](http://www.brightwoodbalddivis.com.au)

**parcel.**

DISCLAIMER: Whilst every care has been taken with the preparation of these particulars, which are believed to be correct, they are in no way warranted by the selling agent or its clients in whole or in part and should not be construed as forming part of any contract. The particulars of this plan are supplied for identification purposes only and shall not be taken as a representation in any aspect on the part of the vendor or its agents. Authorities should be consulted when services are contained within lot boundaries as building restrictions may apply. All retaining walls, services and associated easements are shown exaggerated for legibility. Trees for marketing purposes are indicative only. Street tree locations have been approved by the City of Rockingham. The purchaser and their builder must take notice of these locations prior to submitting a Building Application. The developer is not responsible for the relocation of any street trees. Any intending purchasers are advised to make necessary enquiries to satisfy themselves on all matters in this respect. Sales Agent: Parcel Realty Pty Ltd (ABN 66 153 825 542). Licence number: 64283.

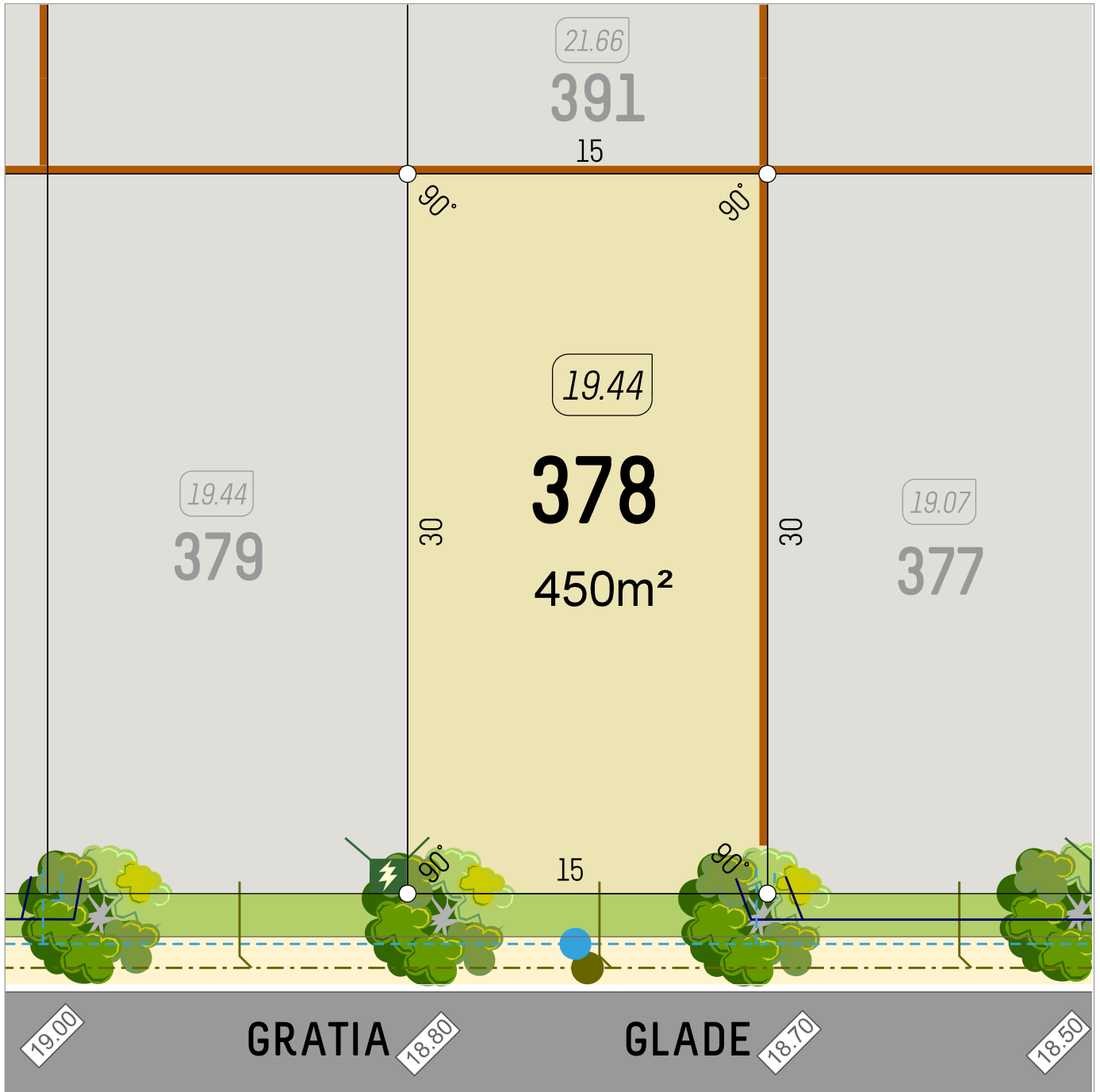

**veris**



SCALE 1:250  
0 5m  
611606 July 2023

- Retaining Wall
- Lot Level
- Footpath

- Street Light
- Drainage
- Power Dome
- Drainage Lot Connection

- Water Service
- NBN Pit
- Sewer Service

**6365 4620** | [info@parcelproperty.com.au](mailto:info@parcelproperty.com.au)  
[www.brightwoodbalddivis.com.au](http://www.brightwoodbalddivis.com.au)

**parcel.**

DISCLAIMER: Whilst every care has been taken with the preparation of these particulars, which are believed to be correct, they are in no way warranted by the selling agent or its clients in whole or in part and should not be construed as forming part of any contract. The particulars of this plan are supplied for identification purposes only and shall not be taken as a representation in any aspect on the part of the vendor or its agents. Authorities should be consulted when services are contained within lot boundaries as building restrictions may apply. All retaining walls, services and associated easements are shown exaggerated for legibility. Trees for marketing purposes are indicative only. Street tree locations have been approved by the City of Rockingham. The purchaser and their builder must take notice of these locations prior to submitting a Building Application. The developer is not responsible for the relocation of any street trees. Any intending purchasers are advised to make necessary enquiries to satisfy themselves on all matters in this respect. Sales Agent: Parcel Realty Pty Ltd (ABN 66 153 825 542). Licence number: 64283.



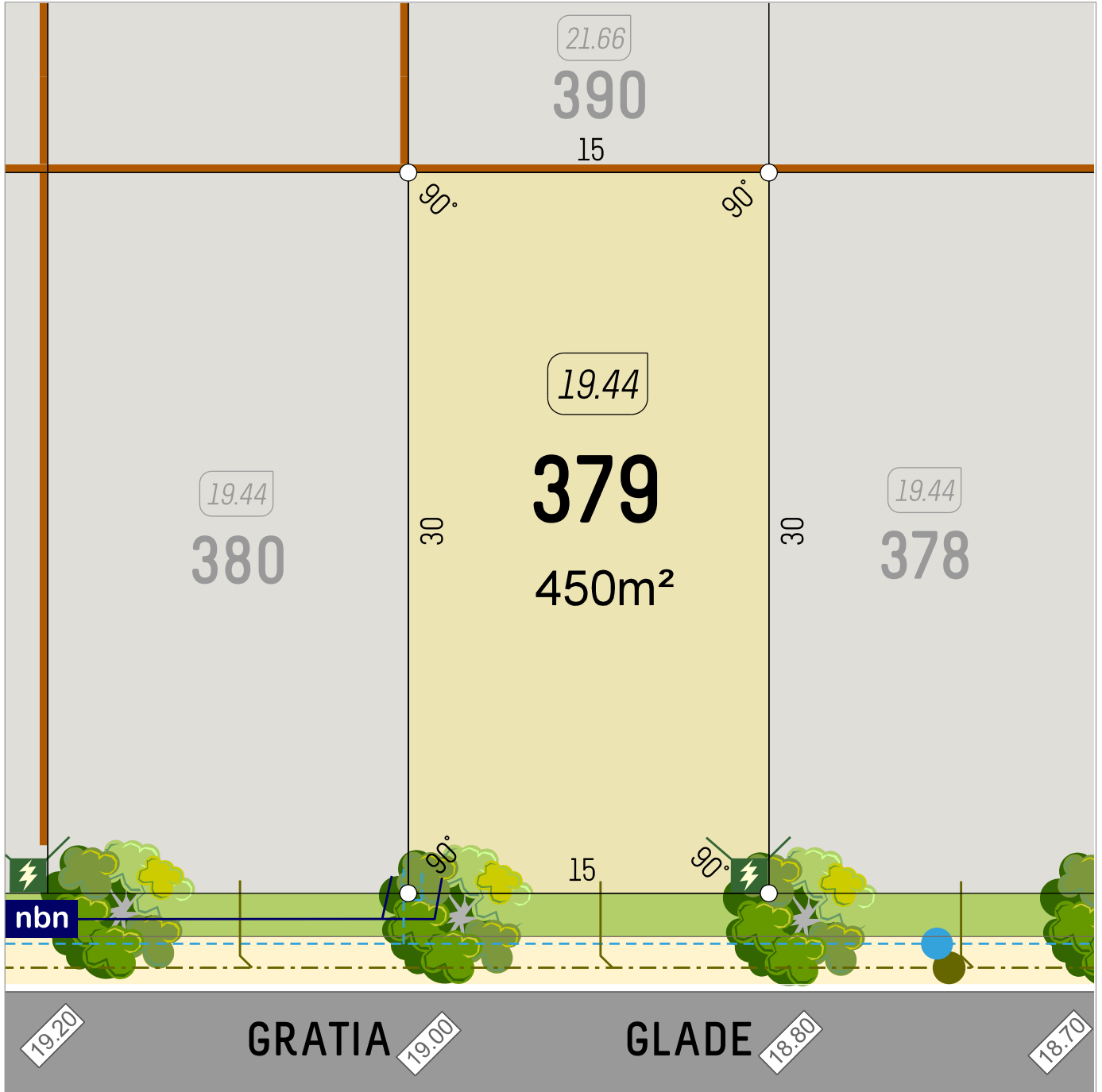

**veris**



SCALE 1:250  
0 5m  
611606 July 2023

- Retaining Wall
- Lot Level
- Footpath

- Street Light
- Drainage
- Power Dome
- Drainage Lot Connection

- Water Service
- NBN Pit
- Sewer Service

**6365 4620** | [info@parcelproperty.com.au](mailto:info@parcelproperty.com.au)  
[www.brightwoodbalddivis.com.au](http://www.brightwoodbalddivis.com.au)

**parcel.**

DISCLAIMER: Whilst every care has been taken with the preparation of these particulars, which are believed to be correct, they are in no way warranted by the selling agent or its clients in whole or in part and should not be construed as forming part of any contract. The particulars of this plan are supplied for identification purposes only and shall not be taken as a representation in any aspect on the part of the vendor or its agents. Authorities should be consulted when services are contained within lot boundaries as building restrictions may apply. All retaining walls, services and associated easements are shown exaggerated for legibility. Trees for marketing purposes are indicative only. Street tree locations have been approved by the City of Rockingham. The purchaser and their builder must take notice of these locations prior to submitting a Building Application. The developer is not responsible for the relocation of any street trees. Any intending purchasers are advised to make necessary enquiries to satisfy themselves on all matters in this respect. Sales Agent: Parcel Realty Pty Ltd (ABN 66 153 825 542). Licence number: 64283.



veris



SCALE 1:250  
611606 July 2023

- Retaining Wall
- Lot Level
- Footpath

- Street Light
- Drainage
- Power Dome
- Drainage Lot Connection

- Water Service
- NBN Pit
- Sewer Service

6365 4620 | info@parcelproperty.com.au  
www.brightwoodbalddivis.com.au

parcel.

DISCLAIMER: Whilst every care has been taken with the preparation of these particulars, which are believed to be correct, they are in no way warranted by the selling agent or its clients in whole or in part and should not be construed as forming part of any contract. The particulars of this plan are supplied for identification purposes only and shall not be taken as a representation in any aspect on the part of the vendor or its agents. Authorities should be consulted when services are contained within lot boundaries as building restrictions may apply. All retaining walls, services and associated easements are shown exaggerated for legibility. Trees for marketing purposes are indicative only. Street tree locations have been approved by the City of Rockingham. The purchaser and their builder must take notice of these locations prior to submitting a Building Application. The developer is not responsible for the relocation of any street trees. Any intending purchasers are advised to make necessary enquiries to satisfy themselves on all matters in this respect. Sales Agent: Parcel Realty Pty Ltd (ABN 66 153 825 542). Licence number: 64283.

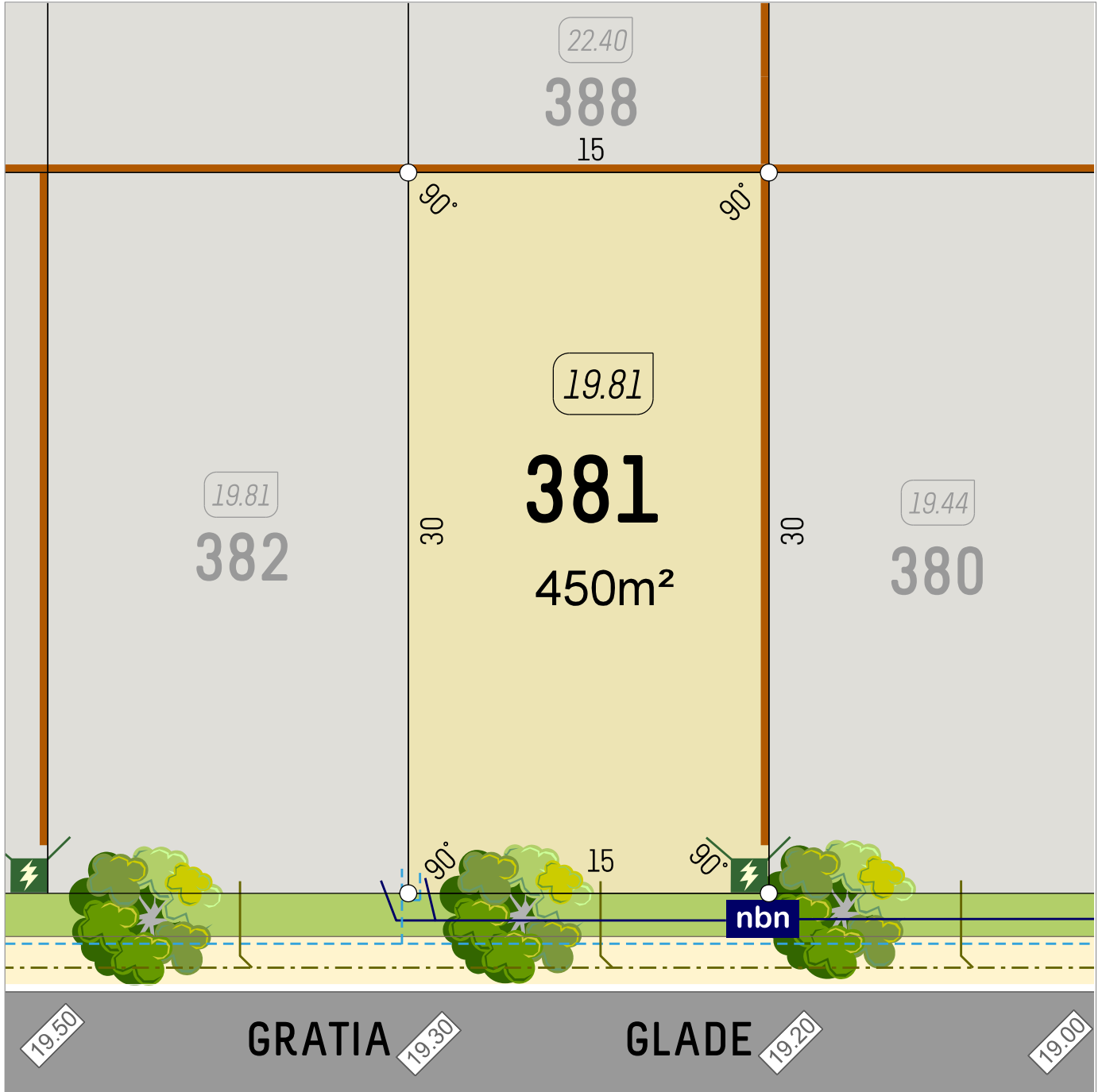

**veris**



SCALE 1:250  
611606 July 2023

- Retaining Wall
- Lot Level
- Footpath

- Street Light
- Drainage
- Power Dome
- Drainage Lot Connection

- Water Service
- NBN Pit
- Sewer Service

**6365 4620** | [info@parcelproperty.com.au](mailto:info@parcelproperty.com.au)  
[www.brightwoodbalddivis.com.au](http://www.brightwoodbalddivis.com.au)

**parcel.**

DISCLAIMER: Whilst every care has been taken with the preparation of these particulars, which are believed to be correct, they are in no way warranted by the selling agent or its clients in whole or in part and should not be construed as forming part of any contract. The particulars of this plan are supplied for identification purposes only and shall not be taken as a representation in any aspect on the part of the vendor or its agents. Authorities should be consulted when services are contained within lot boundaries as building restrictions may apply. All retaining walls, services and associated easements are shown exaggerated for legibility. Trees for marketing purposes are indicative only. Street tree locations have been approved by the City of Rockingham. The purchaser and their builder must take notice of these locations prior to submitting a Building Application. The developer is not responsible for the relocation of any street trees. Any intending purchasers are advised to make necessary enquiries to satisfy themselves on all matters in this respect. Sales Agent: Parcel Realty Pty Ltd (ABN 66 153 825 542). Licence number: 64283.

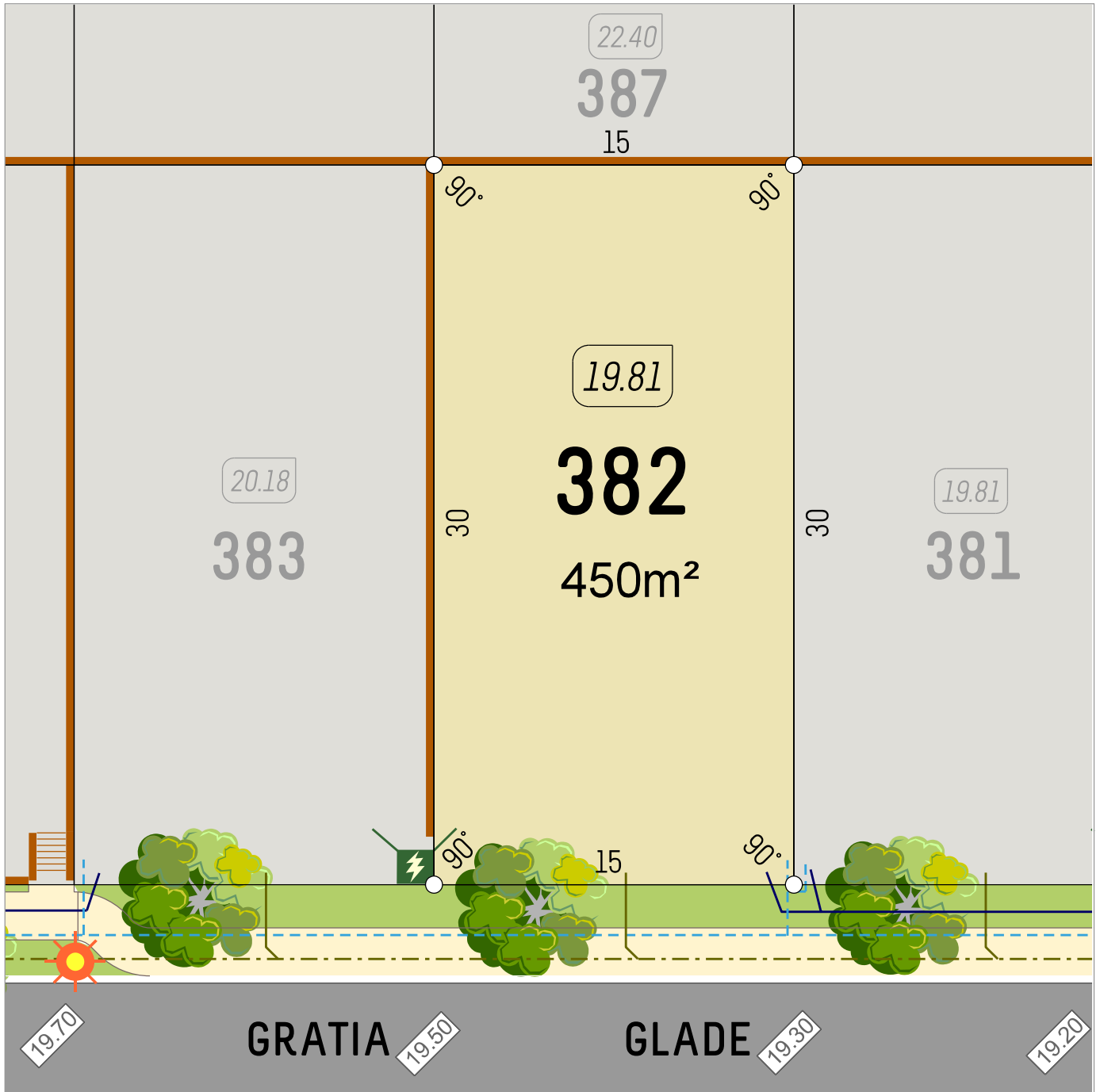

**veris**



SCALE 1:250  
611606 July 2023

- Retaining Wall
- Lot Level
- Footpath

- Street Light
- Drainage
- Power Dome
- Drainage Lot Connection

- Water Service
- NBN Pit
- Sewer Service

**6365 4620** | [info@parcelproperty.com.au](mailto:info@parcelproperty.com.au)  
[www.brightwoodbalddivis.com.au](http://www.brightwoodbalddivis.com.au)

**parcel.**

DISCLAIMER: Whilst every care has been taken with the preparation of these particulars, which are believed to be correct, they are in no way warranted by the selling agent or its clients in whole or in part and should not be construed as forming part of any contract. The particulars of this plan are supplied for identification purposes only and shall not be taken as a representation in any aspect on the part of the vendor or its agents. Authorities should be consulted when services are contained within lot boundaries as building restrictions may apply. All retaining walls, services and associated easements are shown exaggerated for legibility. Trees for marketing purposes are indicative only. Street tree locations have been approved by the City of Rockingham. The purchaser and their builder must take notice of these locations prior to submitting a Building Application. The developer is not responsible for the relocation of any street trees. Any intending purchasers are advised to make necessary enquiries to satisfy themselves on all matters in this respect. Sales Agent: Parcel Realty Pty Ltd (ABN 66 153 825 542). Licence number: 64283.

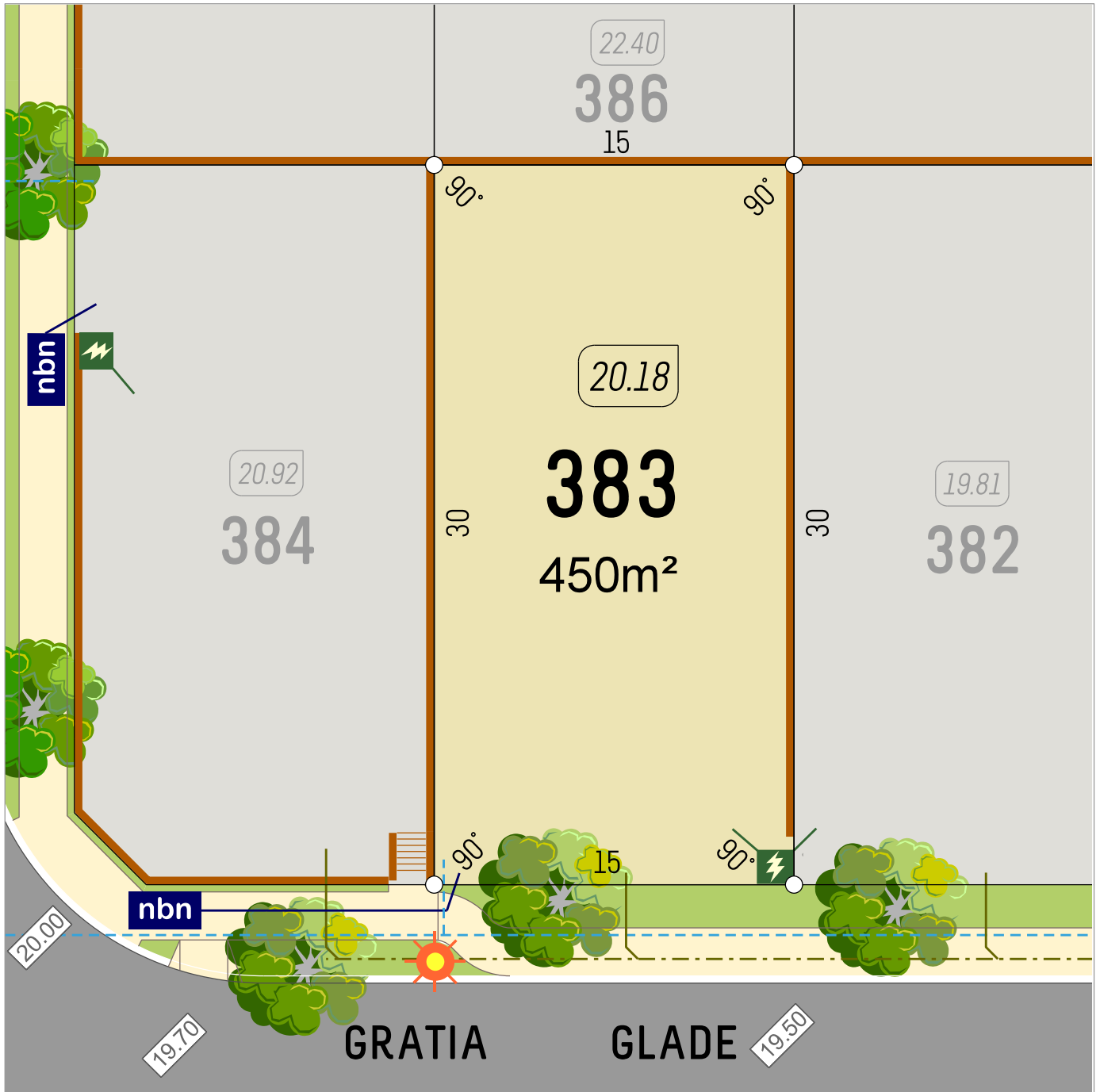

**veris**



SCALE 1:250  
611606 July 2023

- Retaining Wall
- Lot Level
- Footpath

- Street Light
- Drainage
- Power Dome
- Drainage Lot Connection

- Water Service
- NBN Pit
- Sewer Service

**6365 4620** | [info@parcelproperty.com.au](mailto:info@parcelproperty.com.au)  
[www.brightwoodbalddivis.com.au](http://www.brightwoodbalddivis.com.au)

**parcel.**

DISCLAIMER: Whilst every care has been taken with the preparation of these particulars, which are believed to be correct, they are in no way warranted by the selling agent or its clients in whole or in part and should not be construed as forming part of any contract. The particulars of this plan are supplied for identification purposes only and shall not be taken as a representation in any aspect on the part of the vendor or its agents. Authorities should be consulted when services are contained within lot boundaries as building restrictions may apply. All retaining walls, services and associated easements are shown exaggerated for legibility. Trees for marketing purposes are indicative only. Street tree locations have been approved by the City of Rockingham. The purchaser and their builder must take notice of these locations prior to submitting a Building Application. The developer is not responsible for the relocation of any street trees. Any intending purchasers are advised to make necessary enquiries to satisfy themselves on all matters in this respect. Sales Agent: Parcel Realty Pty Ltd (ABN 66 153 825 542). Licence number: 64283.

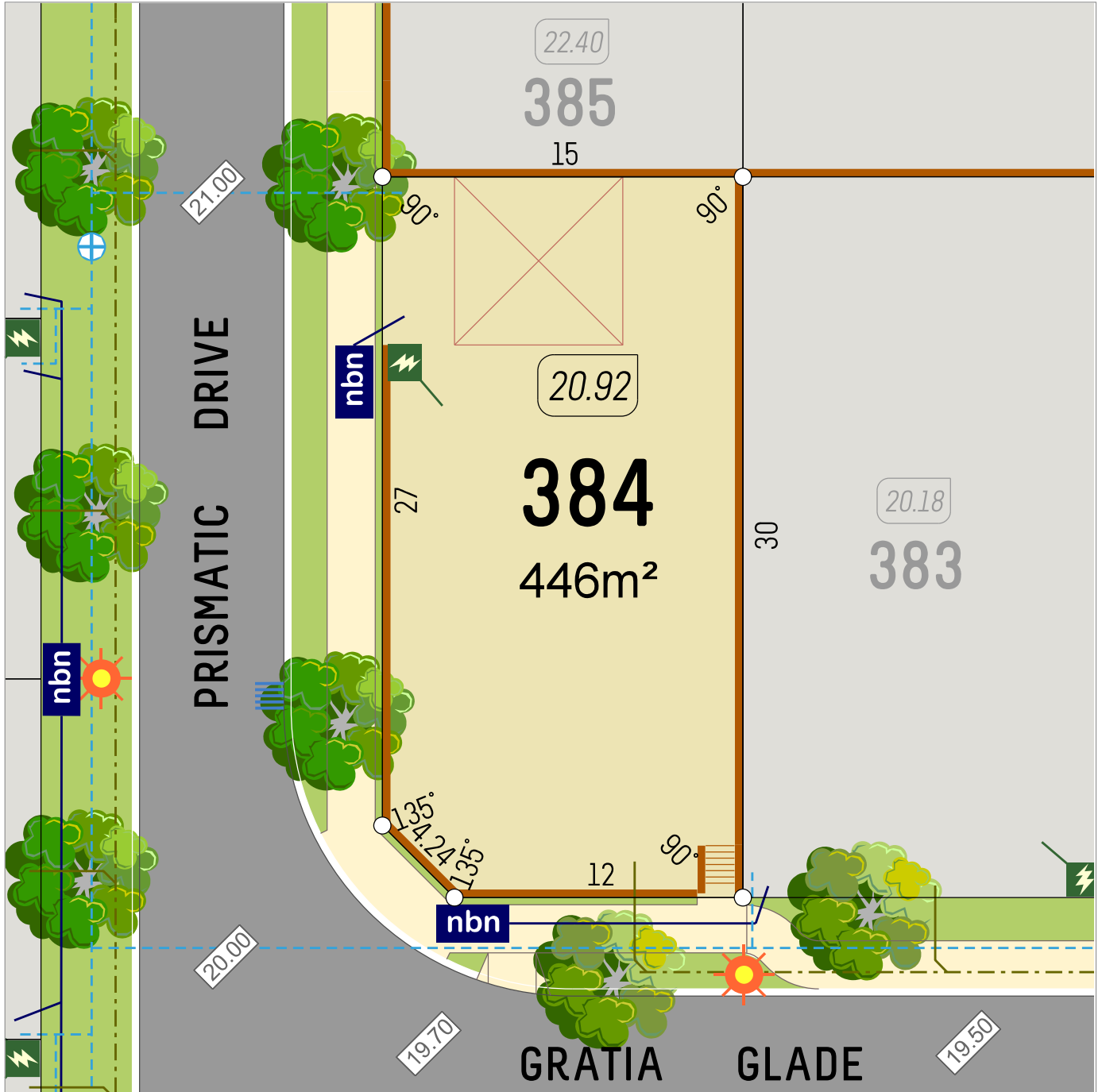

**veris**



SCALE 1:250  
611606 July 2023

-  Retaining Wall
-  Lot Level
-  Footpath
-  Street Light
-  Drainage
-  Power Dome
-  Drainage Lot Connection
-  Water Service
-  NBN Pit
-  Sewer Service

**6365 4620** | [info@parcelproperty.com.au](mailto:info@parcelproperty.com.au)  
[www.brightwoodbalddivis.com.au](http://www.brightwoodbalddivis.com.au)

**parcel.**

DISCLAIMER: Whilst every care has been taken with the preparation of these particulars, which are believed to be correct, they are in no way warranted by the selling agent or its clients in whole or in part and should not be construed as forming part of any contract. The particulars of this plan are supplied for identification purposes only and shall not be taken as a representation in any aspect on the part of the vendor or its agents. Authorities should be consulted when services are contained within lot boundaries as building restrictions may apply. All retaining walls, services and associated easements are shown exaggerated for legibility. Trees for marketing purposes are indicative only. Street tree locations have been approved by the City of Rockingham. The purchaser and their builder must take notice of these locations prior to submitting a Building Application. The developer is not responsible for the relocation of any street trees. Any intending purchasers are advised to make necessary enquiries to satisfy themselves on all matters in this respect. Sales Agent: Parcel Realty Pty Ltd (ABN 66 153 825 542). Licence number: 64283.